



CAUTION: READ ALL OF PAGE AND FIGURE FIRST BEFORE USE

Sommario

1.	Notes of safety	21
2.	Symbols Defined	21
3.	General Power Tool Safety Instructions	22
4.	Special Safety Instructions	24
5.	Purpose	26
6.	Function description	26
7.	Parts List	27
8.	Included Items.....	27
9.	Specification	28
10.	Charging the Battery	29
11.	Working environment.....	29
12.	Operations start procedure	30
13.	Cutting.....	30
14.	Maintenance and cleaning	32
15.	Pruner Storage	35
16.	Waste Disposal and Environmental Protection.....	36
17.	Spare parts.....	36
18.	Warranty.....	36
19.	Troubleshooting and repair	38
20.	Declaration of conformity	39

1. Notes of safety



Before first using the machine, please read this instruction manual carefully, for your own safety and for the safety of others. Keep the manual in a safe place and pass it on to any subsequent owner to ensure that the information therein is available at any times.

2. Symbols Defined

This part includes safety indications for using the machine.

2.1. Symbols in the Manual



Warning symbol



Risk of cutting and severe injuries



Hot surface



Instruction symbol



Read through the instruction manual carefully



Wear protective gloves



Wear eye protection.



Wear protective shoes with non-slip soles



Do not use the pruning shear in the rain or wet hedge or branch.



Do not place with domestic waste.

3. General Power Tool Safety Instructions



Warning! Read all safety directions and instructions.

Omissions in the compliance with safety directions and instructions can cause electric shock and fire and/or severe injuries.

Retain all safety directions and instructions for future use.

The term “Power Tools” used in the safety instructions refers to mains-operated power tools (with power cord) and battery-operated power tools (without power cord).

3.1. Safety of working area

- Keep work area clean and light. Cluttered or dark areas will cause accidents.
- Do not operate power tools in explosive and flammable atmospheres, such

as in the presence of flammable liquids, gases or dust. Power tools create sparks, which may ignite the dust or fumes.

- Keep children and bystanders away while operating a power tool. Distractions can cause you to lose control of power tool.

3.2. Electrical Safety

- Follow the instructions for the charger.

3.3. Power Tool Use Safety

- Do not over load the tool, select suitable tool to work make you safe and high efficiency.
- Do not use the tool if the switch doesn't work properly. Tool should be repaired if the switch doesn't work.
- Store the tool away from the children, do not put tool to non-training person operate.
- Maintain tools. Always check tool, moving parts, any damage parts are all can cause injury, the correct maintenance of the tool can avoid injury.
- Keep blade sharp and clean. Sharp and clean blade can be easily controlled and not jams.
- Read manual before using the tool, select suitable tools and right accessories to avoid injury.

3.4. Battery-Operated Tool Precautions

- Inappropriate usage will cause leakage of liquid. If your body is splashed by the liquid, please flush by clean water. Must see a doctor if liquid touches eyes. Liquid of battery will canker or burn.

3.5. Personal safety

- Be awake, alert and pay close attention during the operation of power tools. Do not operate the power tool when you are tired, intoxicated or on medication. Falling asleep or losing consciousness during in the operation of the power tool can result in serious personal injury.
- Use personal protective equipment. Always wear goggles and safety equipment such as dust masks, non-slip safety shoes, hard hats, hearing protection, etc. Wearing safety gear in appropriate conditions can reduce personal injury.
- Inserting the plug when the tool is plugged in or when it is turned on can be dangerous.

- Remove all adjustment keys or wrenches before the power tool is on. A wrench or key left on the moving parts of the power tool can cause personal injury.
- Do not overextend your reach and lose balance. Always pay attention to your foothold and body balance. This allows for good control of the power tool especially during unexpected situations.
- Dress properly. Do not wear loose clothing or jewelry. Keep clothing, gloves and hair away from moving parts. Wearing loose clothes, accessories, or long hair may get caught in moving parts.

4. Special Safety Instructions

4.1. Pruning shear special safety instruction

- Keep anybody away at least 1.5m from the blade, do not move cutting parts at blade working.
Keep any part of your body away from the blade at least 15cm. Carefully operate the equipment can avoid injury.
- Move the tool at blade not moving. Protection guard is must at storage the tool. Protect blade to reduce damage.

4.2. Other Safety Instructions



Wear suitable work clothes such as boots with non-slip soles, sturdy long trousers, gloves and goggles.



Wear protection gloves



Wear eye protection

- Do not wear long flowing clothing or jewelry, as moving parts may catch this.
- Stay alert, watch what you are doing, and use common sense when operating the tool. Do not use a power tool when you are tired or under the effect of drugs, alcohol or medicines.
- Do not use the pruning shear in the rain.

- The appliance is designed for trimming hedges or branches. Do not use to cut twigs, hard wood or other objects.
- Do not attempt to dislodge a blocked/trapped blade before switching the tool off.
- Before start with the trimming check the hedge or branch for hidden objects such as wire etc.
- When operating the tool hold it firmly with one hand, and keep the blade at least at 15cm from the other hand and other parts of the body
- Do not use the tool in the proximity of flammable liquids or gasses. Fire and explosion risk exist in the event of a short circuit.
- The blades have to be checked for wear in regular intervals and reshape ended. Blunt blades will overload the machine. Resulting damages are not covered by warranty.
- Do not attempt to repair the tool your-self, bring the tool to our Service Center in case of need. All works, which are not described in this manual, may only be performed by our Service-Centre

4.3. Special safety instruction for battery tool

- Do not disassemble the battery; do not damage battery, in order to avoid injury.

4.4. Use charger correctly

- Follow the instructions for the charger

4.5. Caution (Residual risk)

Keep use the tool carefully avoid risk as below:

- Cutting or injuries due to sharp edges
- Long times operate or irrationally use the tool will damage your body.



Warning!

The equipment will bring electromagnetism; it can interfere with some medical device in body. It is suggested to ask for doctor advise before the usage of the tool at the same time with medical devices.



Warning!

Do not touch the blade when the battery is mounted on the tool. Keep a minimum distance of 15cm between the blades and any part of your body. Keep other people at a minimum distance of 1.5m



Warning!

In particular situations of very hard use, the blade and the handle could reach high temperatures. It is recommended to handle the pruner with care, using protective gloves.

Sound and vibration measurements:

Sound pressure level: < 70 dB(A)

Total vibration value: < 2.5 m/s²

5. Purpose

The device is designed only for cutting hedge, brush, and branch.

Other not suitable work may damage tool and yourself.

The equipment is designed for adult use, Do not use in rain or damp brush. Vendor is not responsible for any damage due to not following the instructions in this manual.



Check blade sharpening before to use the tool. Blade should be sharp before to use. Damages due to use of a blunt blade are not covered by warranty.

6. Function description

The blade and counterblade are made of high-quality and high-strength Japanese SK5 steel. Its high strength and lightweight design make it easy to use with one hand. The progressive cutting mode allows you to control the movement of the blade and bring it as close as possible to the branches by adjusting the blade opening to the diameter to be cut.

In case of danger or malfunction, release the trigger and the blade will open fully to prevent damage or injury.

7. Parts List

- | | |
|------------------------|-----------------------|
| 1) Cutting blade | 6) Grip |
| 2) Fixed blade | 7) Switch + Display |
| 3) Blade fixing system | 8) Integrated battery |
| 4) Trigger | 9) USB socket |
| 5) Led | 10) USB-C Cable |

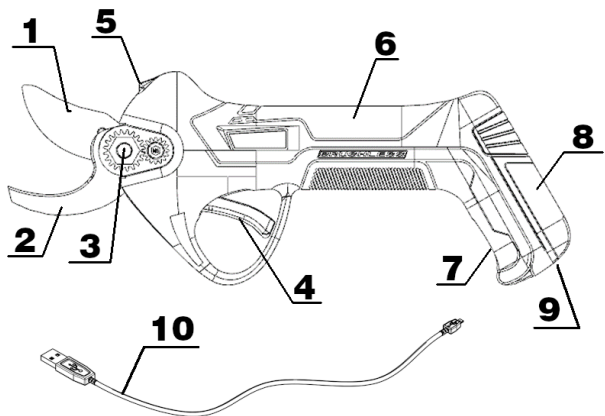

8. Included Items

Please carefully open the package and check that the parts are complete:

- Electric Pruning Shears
- USB-C cable
- Tools
- Holster
- Instruction Manual

8.1. Display screen



Percentage	Indicator light
100%	Four green LED flashes
75~99%	Three green LEDs, one red LED flashing
51~75%	Two green leds, two red leds flashing
26~50%	One green LED, three red LED flashing
0~25%	Four red LED flashes
Percentage	Indicator light
76~100%	Four green leds
51~75%	Three green leds, one red LED
26~50%	Two green leds, two red leds
11~25%	One green LED, three red LED
0~10%	Four red leds

9. Specification

Pruning Shear specifications		
1	Maximum blade opening	22mm
2	Rated Voltage	7,2Vdc
3	Rated Power	180W
4	Rated Current	50A
5	Weight	0,75 kg

Integrated Battery (lithium-ion)		
1	Capacity	4000mA
2	Voltage	7,2V
3	Operating Hours	3 ~4H*
Charger (optional)		
1	Output Voltage	5V
2	Charging Time	3~4H

10. Charging the Battery

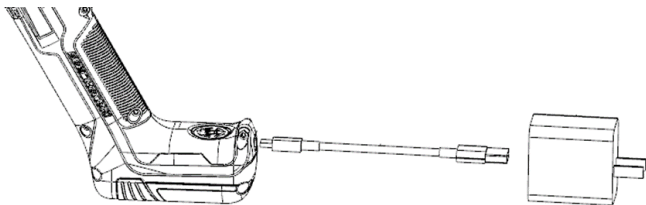

- Connect one end of the USB-C cable (10) to the pruner charging slot (9) and the other end to the charger (not supplied – a mobile phone charger can be used, after checking the indicated output voltage in the technical specifications).
- After that, the red light in the LED display area (7) will be on.
- At the end of the charge four green lights will be on.
- Disconnect the cable after charging.
- Make sure the battery is recharged at least every 3 months when it is not in use.

11. Working environment

- Keep temperature of environment at 10°C ~ 45°C when charging battery, 0°C ~ +45°C when battery is working.
- Keep tool at temperature of 0°C ~ +60°C when working
- Do not use in explosive atmosphere or near flammable substances or gases.
- Do not use in case of rain or on wet branches

12. Operations start procedure



Please wear suitable cloth and glove when operate this tool. Always check tools before use, make sure on/off switch and safe switch are all ok. The power should be put off when you loosen the trigger. Stop using the tool in case of switch failure. Always check rated voltage of battery match pruning shear.



Switch off the machine, blade will stop in many second, must sure blade stop fully before touching it, otherwise blade will hurt your body.

- Switching on: Press the power button. After the LED lights up, press the trigger twice in rapid sequence to open the blades.
- Do not exceed the cutting dimensions to protect the scissors and battery from possible damage. Do not cut larger branches than those indicated in the technical specifications.
- Release the trigger if the blade is blocked, the blade will automatically return to the maximum open position.
- Switching off: Keep the trigger pressed for three seconds, then press the power button for three seconds until it shuts down completely.
- LED light: keep the trigger pressed for five seconds, the LED will turn off; keep the trigger pressed for another five seconds, the LED will turn on.

Caution: Do not sway the pruner from the left to right in order not to damage the edge of blade during the resume process of blade.

Check the working frequency of the blade in order to verify the good working condition.

13. Cutting



Wear suitable work clothes such as boots with non-slip soles, sturdy long trousers, gloves and goggles.



Wear protection gloves



Wear eye protection



Warning!

In particular situations of very hard use, the blade and the handle could reach high temperatures. It is recommended to handle the pruner with care, using protective gloves.

- When ready to cut, place the blade on the branch to be cut and press the trigger;
- When operating the tool, keep the other hand and any other part of your body at a minimum distance of 15cm from the blade;
- Keep all other people at a minimum distance of 1.5m
- Blade will be hurt or jammed if cutting bigger branch forcedly.
- Do not move the tool during the pruning shear cutting, it can cause danger.
- Do not use the device in rain or humidity environment.



Caution: please check battery charge level or blade sharpening when cutting is difficult or not smooth.

13.1. Opening change

The KV220 pruner is equipped with a blade opening change system with memory. It means that it is possible to adjust the opening of the blade according to the desired cutting diameter.

The opening of the blades can be adjusted in two positions:

- 100% blades opening (default start opening).
- Approx 70% blades opening

Procedure to adjust the opening of the blade:

- Press the power button. After the LED lights up, press the trigger twice in rapid sequence to open the blades - 100% blade opening.



Risk of cutting and severe injuries

- Press and hold the trigger for two seconds. After an acoustic signal - blades open at about 70%.
- Press and hold the trigger for two seconds. After an acoustic signal - 100% blade opening.

14. Maintenance and cleaning



Tools to be repaired must be sent to Customer Assistance Service. Use original part keeps the tool good condition and safe.



Disconnect the battery from the tool before checking, maintaining and repairing the pruning shear, to avoid risk of unexpected activation of the tool.



Warning!

In particular situations of very hard use, the blade and the handle could reach high temperatures. It is recommended to handle the pruner with care, using protective gloves.



Please wear glove before you check the blade is sharp or not, that is to avoid blade hurt you. Check the pruning shear frequently, this will keep tool safe and reliable.

- Do not flush the tools or put it in water, it will cause short circuit or damage the device.
- Keep ventilation, motor and handle cleaning, always use feather clean the device. Do not use cleanser flush device, it will rust parts.
- Clean the blade after every use, protect by oil or spray protection.
- After continuous work for 8 hours, please open the trigger cover protection of the equipment and clean up wood chips and other impurities

14.1. Sharpening

- Sharpening is very important to keep blade in good condition and ensure long life.
- Always check blade is in good condition before to start work. Of course, the frequency of sharpening depends on the nature of the sheared wood (hardness and diameter), pruning rate and sharpening tools (special abrasive tools are provided).
- As a result, the blade must be checked frequently during the initial period of use to determine the appropriate grinding time (check every 15 minutes and you will quickly calculate)

14.2. Greasing of the blades

The greasing of the blades has to be repeated each 2-3 working days to guarantee the correct performance of the tool and to avoid the seize of the blades.

- Open the blades of the pruner.
- Turn off the tool.
- Apply the grease between the moving blade and the fix blade (see the picture below).
- Turn on the pruner and pull the trigger sometimes to get the grease through the blades.
- Clean the blades from the grease leftover.



14.3. Disassembly and grease

General maintenance, cleaning, lubrication and blade replacement requires some disassembly and assembly of your pruner.

It is recommended to grease the gears each 3-4 working days to guarantee the correct operating life of the tool.

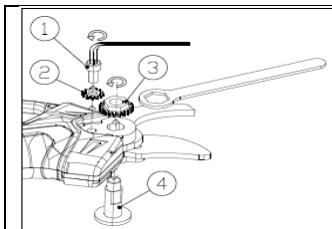

Remove the screw (1) and the adjustment clip (2).
Loosen the nut with a wrench and remove (3). Remove the center screw (4).

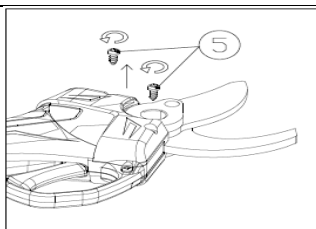

Unscrew the cover screws (5).

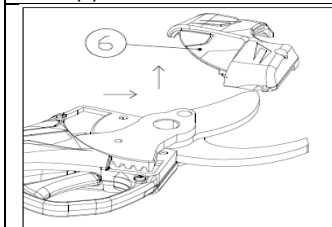

Remove the cover (6).

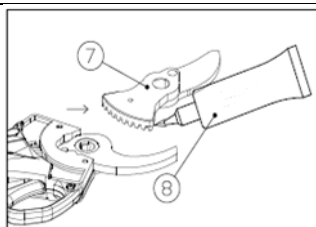

Remove the blade (7) and apply grease (8) on the teeth.

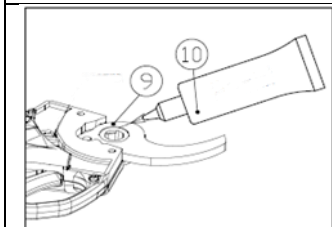

Clean the old grease (9) and apply grease on the counter blade (10).

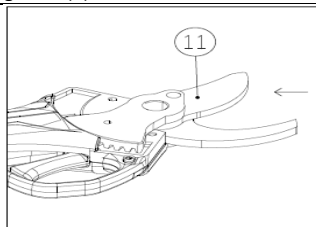

Insert the blade again (11).

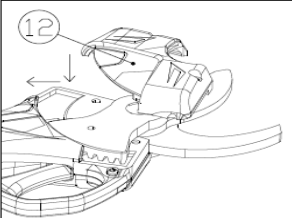
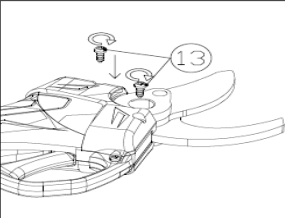
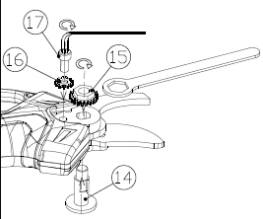
	
<p>Place the cover (12).</p>	<p>Tighten the cover screws (13).</p>
	<p>Insert the central screw (14). Tighten the nut with a wrench (15). Place the clip with the nut and assemble the screw (16). Tighten the screw with an M4 Allen wrench (17).</p>

15. Pruner Storage

The most important thing to keep in mind before storing your pruner's lithium ion batteries is to make sure that the batteries are fully charged up. Storing your tool for long extended periods with little or no charge will damage your battery and void your warranty.

- Ensure that the battery is fully charge.
- Avoid storing the device in extremely hot or cold environments.
- Tool should be stored in a dry environment.

Recommended storage temperatures:

Storage less than 1 month	-20°C ~ +60°C
Storage less than 6 month	-10°C ~ +35°C
Storage over 6 month	0°C ~ +30°C

- The tool and flammable matter must be kept at least 5-feet apart.
- In order to ensure the service life of the equipment and to prevent its degradation, it must be stored with enough battery power.
- When not in use, charge the battery at least once every 4 months.

16. Waste Disposal and Environmental Protection

- Recycle separately tool, accessories and package to kind of waste.



-  LI-ION The equipment is not part of household waste, do not fire (danger of explosion) or water. In case of the leakage of toxic gas or liquid, damaged battery may cause potential environmental and personal health risk.
- Send the equipment to a recycling center. The metal and plastic in the equipment can be recycled after be screened. For detailed information, please contact the Service Center.
- Before discarding the toll, please use up electricity. Do not open the integrated battery.
- Dispose the tool according to local regulations. The tool with the integrated battery shall be sent to a recycling station for environmental-friendly recycling. For detailed information, please consult your local waste management agency or our service center. Dispose the pruned branches in the designated stacks. Do not dispose them with household waste.

17. Spare parts

The manufacturer can supply high quality original replacement blades. Contact our service center in case of need.

18. Warranty

24 months warranty for private users and 12 months warranty for professional users. It covers core parts, including motor and transmission mechanism.

Following conditions invalidate the warranty:

- Abnormal use of tools and overexertion
- Tool not maintained as per the Maintenance Instruction
- Tool modifications
- Any damages even if made by mistake
- Damaged after amateurish repairing.
- Nature caused damages

- Battery not recharged with the requested frequency
- Components subjected to wear (such as blades) during normal operation are not covered by warranty.

The warranty is valid only for products that have been registered through the website within 30 days from the purchase date.

For more information you can write to

info@volpioriginale.it

Activate the warranty for your new tool through our website :

<https://www.volpioriginale.it/registra-il-tuo-prodotto/>



The buyer must also keep a copy of the sales document (receipt, invoice) and of the warranty registration: a copy of these documents must be given to the Dealer or Authorized Customer Service together with the machine to be repaired. In the absence of these documents, the machine will in any case be considered out of warranty.

19. Troubleshooting and repair

Problem	Possible Reason	Corrective Action
Pruner doesn't start	Battery out of charge	Charge Battery
	On / off switch failure	Send to repair service center
Intermittent Operation	Loose internal connections	Send to repair service center
	On / off switch failure	
Hot Blades	Blade dull	Sharpen or replace the blade
	Blade gap	Sharpen or replace the blade
	Poor lubrication, resulting in excessive friction	Lubricate blade
Poor Trimming Performance	Lubrication is not in place, resulting in excessive friction	Lubricate blade
	Dirty blade	Clean blade
	Blade dull	Sharpen or replace the blade
	Trimming quality is poor	Read the instructions carefully
	The battery is not fully charged	Charge the battery

20. Declaration of conformity

CE DECLARATION OF CONFORMITY

Translation of the original text

GB

The Company
Davide e Luigi Volpi S.p.A.



Via San Rocco, 10 – 46040 Casalromano (MN) ITALIA

DECLARES THAT THE MACHINE

Type:	Pruner
Code:	KV220

**IS IN CONFORMITY WITH THE RELEVANT COMMUNITY HARMONISATION
LEGISLATION:**

DIRECTIVE 2006/42/CE
DIRECTIVE 2014/30/UE
DIRECTIVE 2014/35/UE

Machinery Directive
Electromagnetic Compatibility
Low Voltage Directive

Reference to the relevant harmonized standards used or references to other technical specifications for which conformity is declared:

UNI EN ISO 12100:2010	EN 60745-1:2009
EN 55014-1:2017	EN 60335-1:2012
EN 55014-2:2015	EN 60335-2-29:2004
EN 61000-3-2:2014	EN 62233:2008
EN 61000-3-3:2013	EN 62133:2013

Authorized person to set up the technical documentation:

Name:	Davide e Luigi Volpi S.p.A.
Residence:	Via San Rocco 10 – 46040 Casalromano (MN) Italia

This Declaration of Conformity is issued under the sole responsibility of the manufacturer.

Casalromano, September 30, 2021

The legal representative
Eligio Volpi

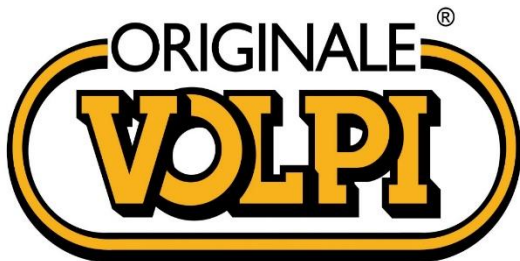

Davide e Luigi Volpi S.p.A.

Via San Rocco, 10 – 46040 Casalromano (MN) Italy

www.volpioriginale.it - info@volpioriginale.it

YLBKV220_2-Libretto d'uso_ITA_ENG